



Islington Street Corridor Project Public Informational Meeting



October 19, 2016



Meeting Agenda

Presentation:

- Meeting Purpose
- Project scope
- Design Considerations
- Infrastructure Design
- Streetscape Design
- Next Steps

Public Comment

Meeting Purpose

- Provide a project update
- Present the preliminary design
- Receive public feedback

Project Limits



Project Scope:

- Upgrade Municipal Utilities
- Reconstruct Roadway and Sidewalks
- Improve ADA / Ped Accommodations
- Improve Roadway Geometry
- Enhance the Streetscape
- Upgrade Lighting
- Replace Traffic Signals

Utility Upgrades:

- Sewer
- Stormwater
- Water
- Gas
- Power
- Communications



Why Upgrade?

- Infrastructure in Portsmouth exceeds 100 years of age.
- Aging infrastructure is susceptible to breaks, resulting in interruptions of water service and sewer back-ups.
- The City continues the ongoing effort to eliminate combined sewer/drainage systems.
- Reduce combined sewer overflow (CSO) events
- Reduce groundwater infiltration into the sewer system.

Why Upgrade?

- Eliminate sewer mains across private property.
- Provide designated utility corridors to minimize future conflicts and improve access for maintenance/repairs.
- Replacement of utilities during roadway reconstruction reduces the need of having to excavate in newly constructed roads to repair and/or replace a utility.
- Relocate overhead utilities underground when practical.

Existing Underground Utility Inventory

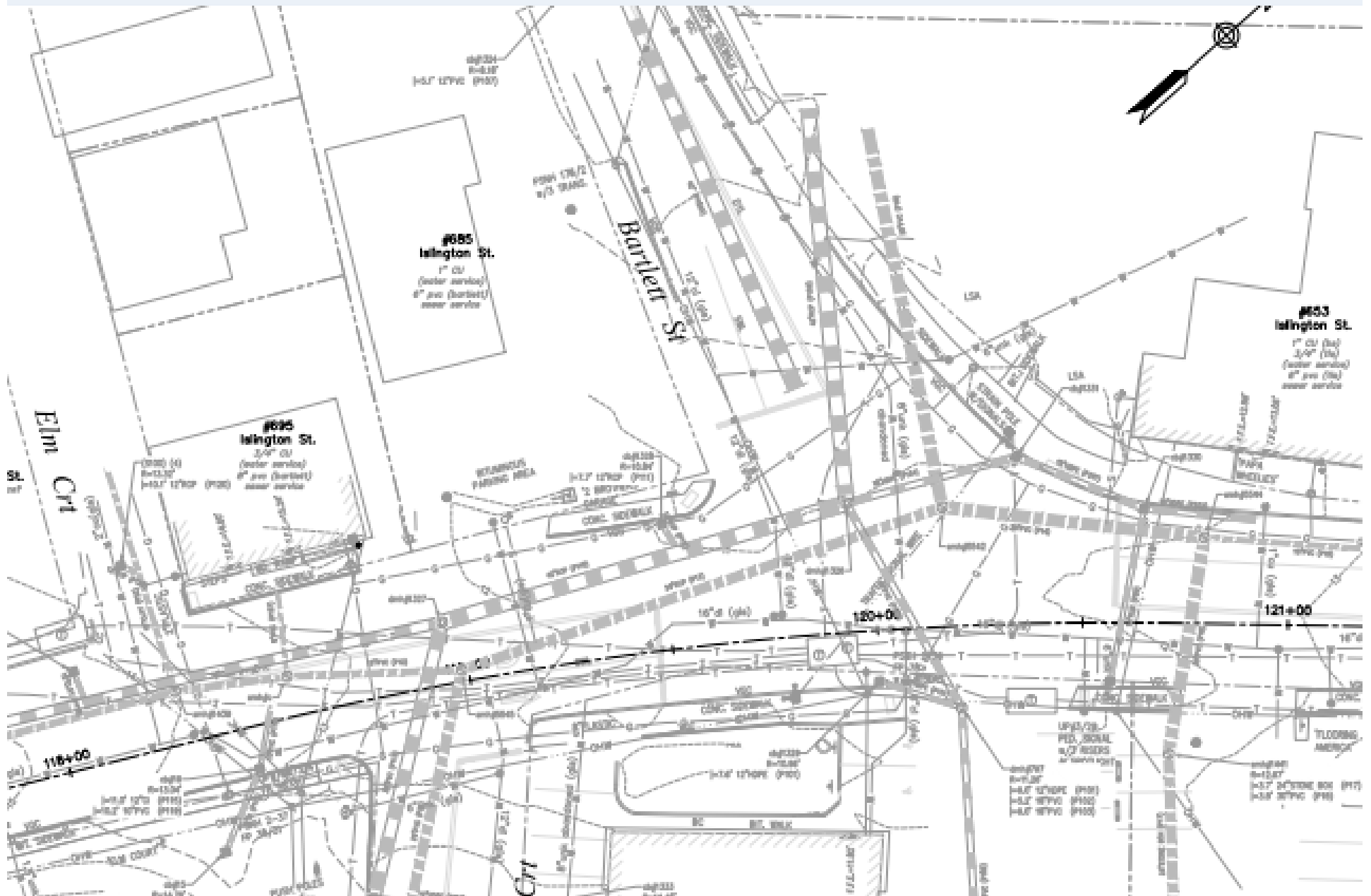

Existing Underground Utility Inventory

Ground Survey

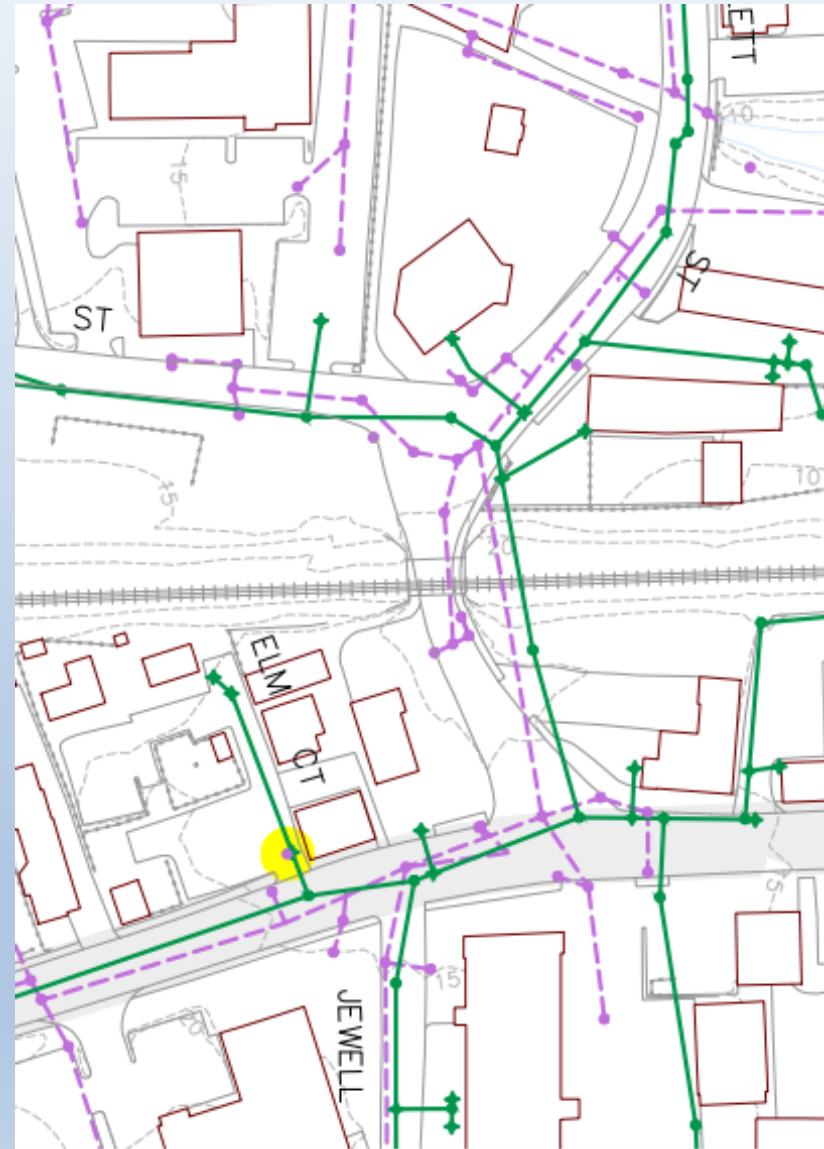
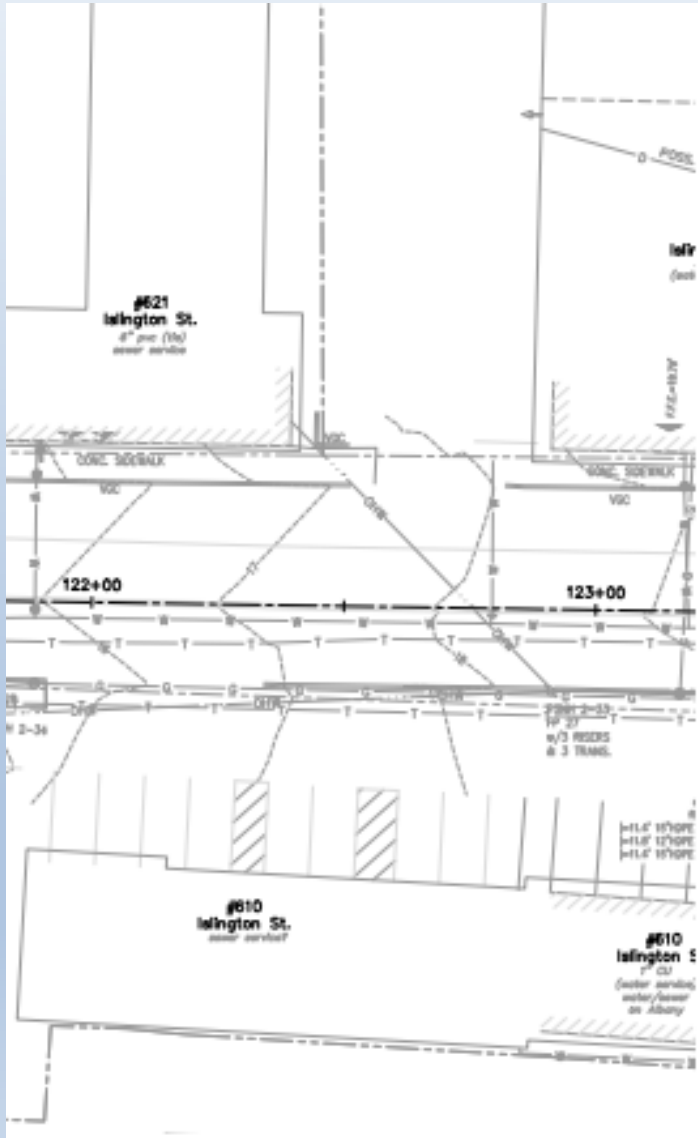

City Mapping

Existing Underground Utility Inventory

City Tie Sheets

PORTSMOUTH WATER WORKS

NO. 392/394 STREET ISLINGTON ST.

SIZE OF SERVICE _____

MATERIAL _____

TYPE OF BOX _____

*Renewed from main
to curb 8-18-1916*

19.8'

33.6'

#392 | #394

Main St.

Islington St.

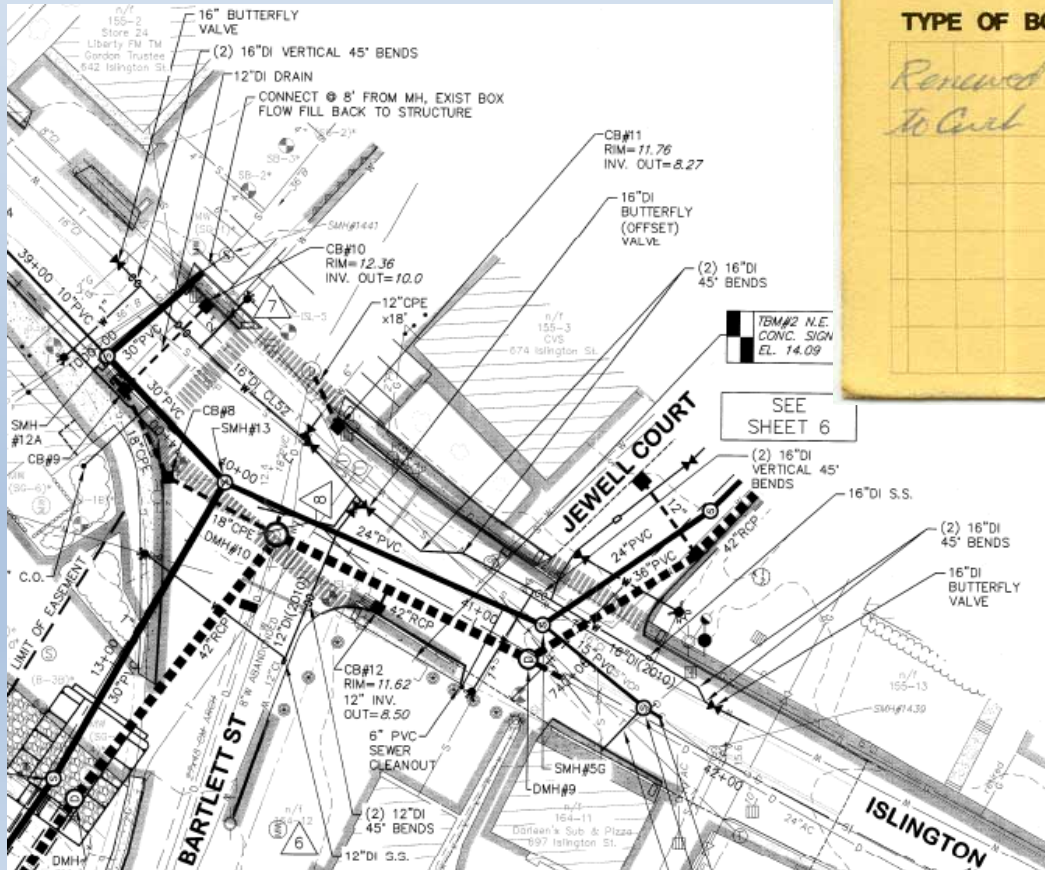

Project Record Drawings

Existing Underground Utility Inventory



Gas Schematics

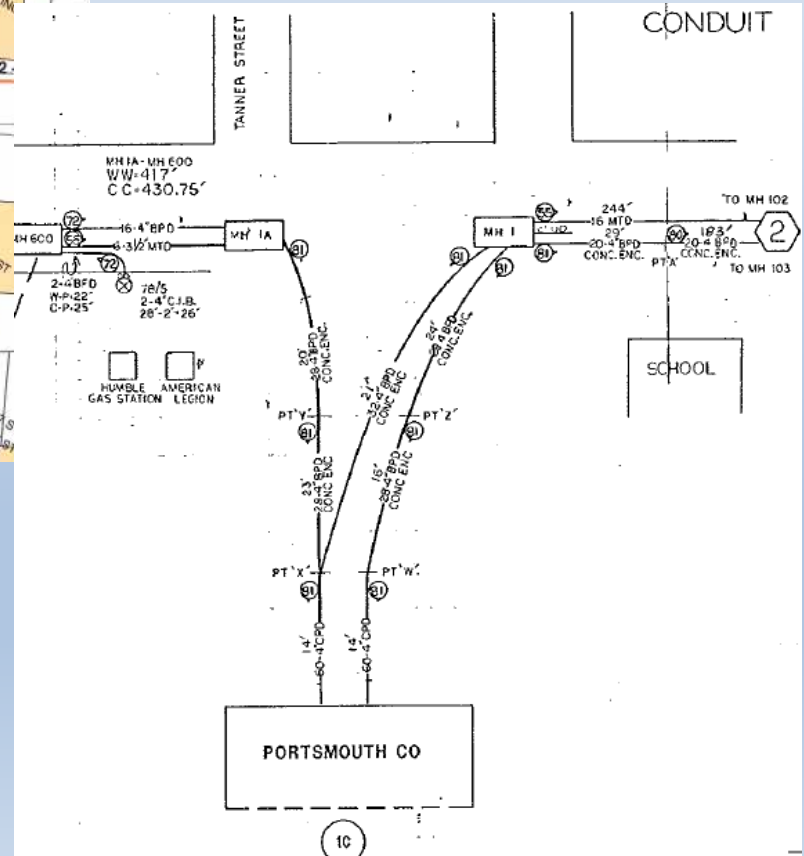

FairPoint Schematics

Existing Underground Utility Inventory



Closed Circuit Video Work



Basement Inspections



Why Basement Inspections?

- Sewer service Information
 - Location of exit
 - Depth of services,
- Water service Information
 - Location, size, material
 - Owners are encouraged to replace old steel service pipes

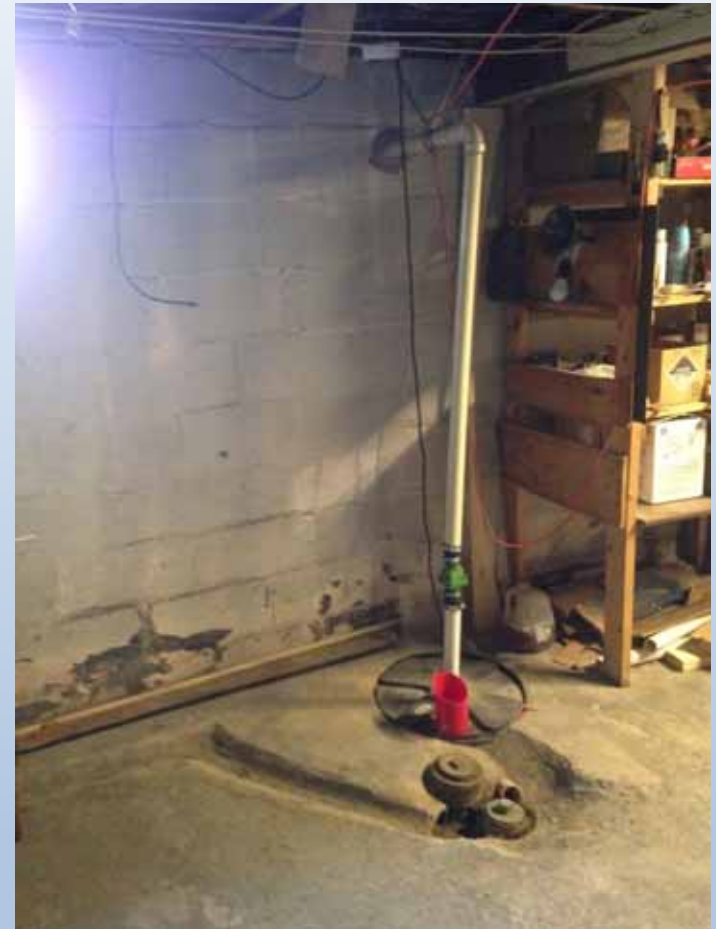

Why Basement Inspections?

- History of sanitary sewer back-up and/or basement flooding
- Identify sump pumps, open floor drains, roof drains and yard drains



Basement Inspection Results



Your Participation is Important!

Basement Survey Sign-Up Sheet (Sewer/Water/Drainage)

Public Information Meeting
Islington Street Re-Construction project
Portsmouth, NH
October 19, 2016

--

Name	Address	Phone	Email

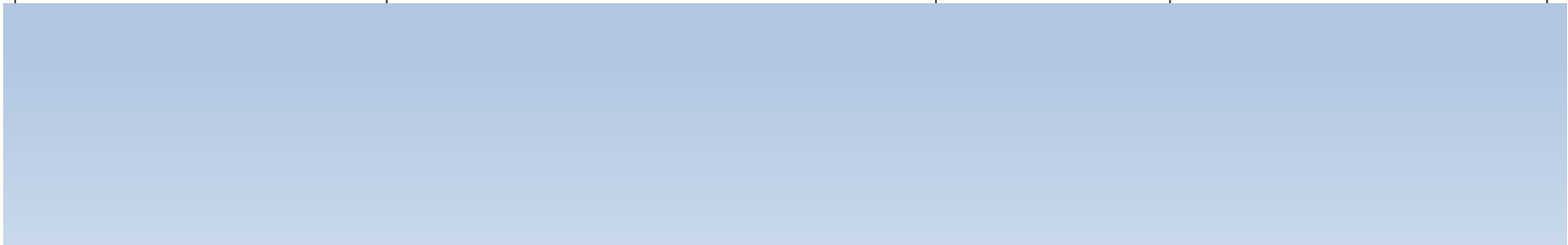

Underground Utilities Work Plan

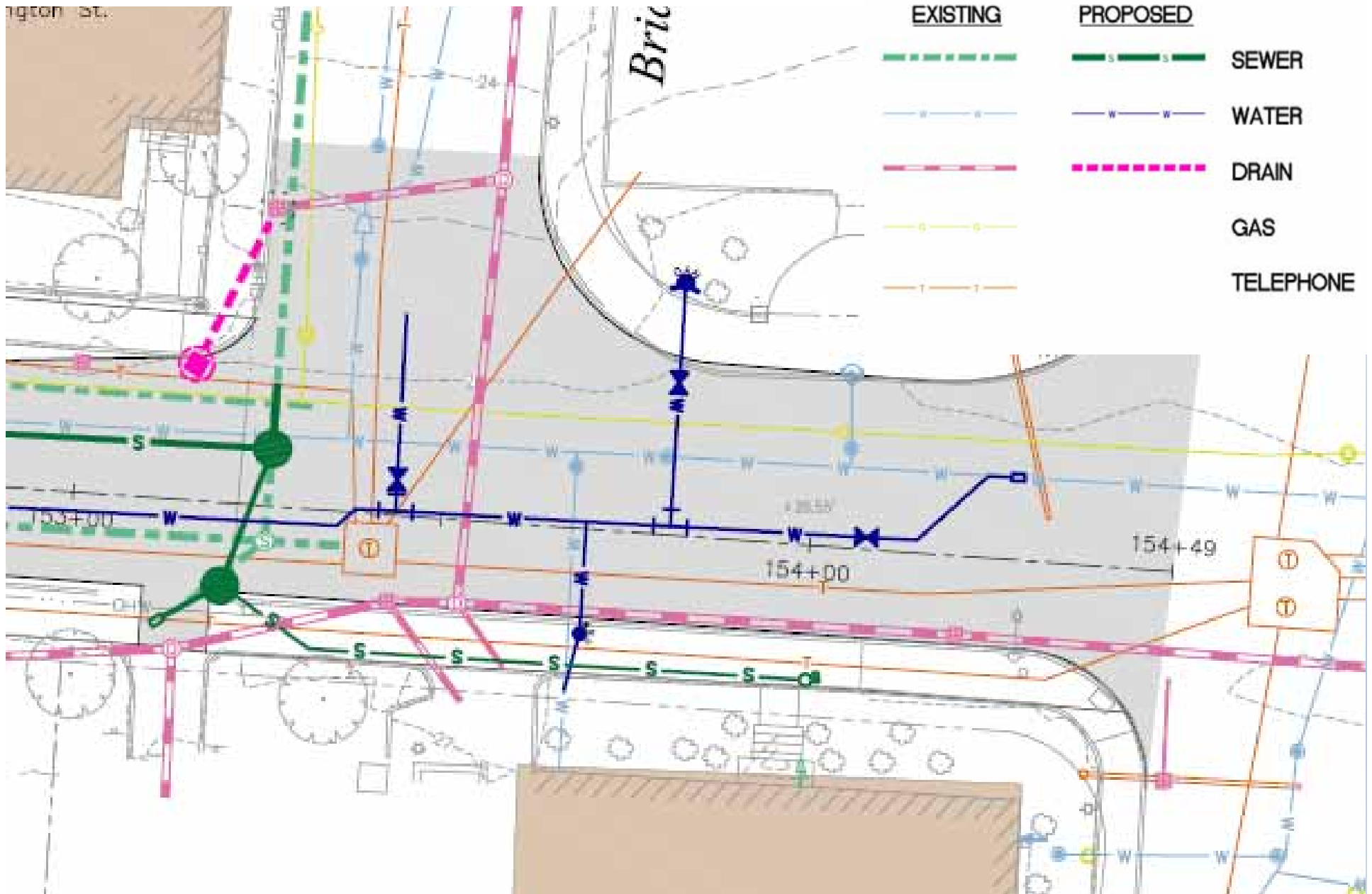

Utility Upgrades – Special Considerations

- Provide a sewer service for future connections to properties with cross country services
- If a cross country sewer main is to be abandoned, interior plumbing work may be required
- Provide a drain service to each property for connection of sump pumps and/or roof leaders

Utility Upgrades – Special Considerations

- Maintain water (and fire) service to all properties for the project duration
 - Notifications for scheduled interruptions (water)
 - Temporary water systems

- Construction Sequencing
 - Utilities are installed deepest to shallowest
 - Phased construction (limit disturbed area)

- Traffic Control
 - Maintain one lane of traffic during construction
 - Impacts are anticipated

Roadway Borings

- Determine Pavement Materials and Thicknesses
- Approximately 40 Borings Planned in 2016



Roadway / Sidewalk Reconstruction

- Phased Construction Anticipated
- Traffic Management Critical
- Pedestrian Access Maintained
- Maintain Public Outreach During Construction



Roadway Geometry Modification Opportunities



Crosswalk Bump-out Examples:



Crosswalk Bump-out Examples:



Main Street, St Albans, VT

White Heron Bump-out Trial:



Bartlett Corner Radius Trial:



Bike and Ped Considerations:



Bike and Ped Considerations:

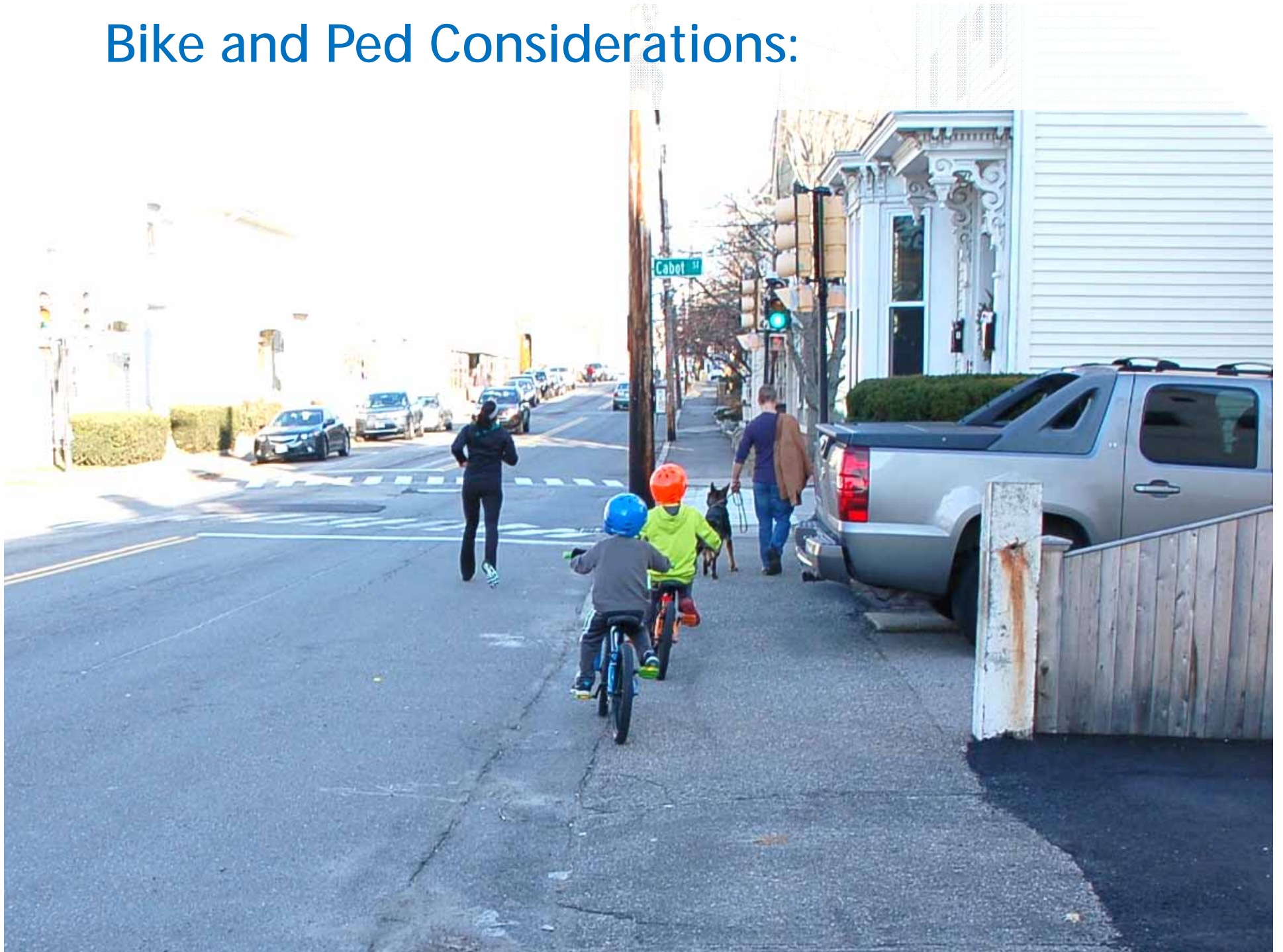

Project Considerations: Constrained width



Project Considerations: Constrained Width



Project Considerations: Sidewalk Space



Project Considerations: Sidewalk Condition



Project Considerations: Adjacent Landscape



Project Considerations: Access Management



Project Considerations: Undefined Road Edge



Project Considerations: Parking & Transit



Traffic signals

- Bartlett Street
- Cabot Street



Project Context

- Character-based zoning
- Surrounding redevelopment potential
- Arts community

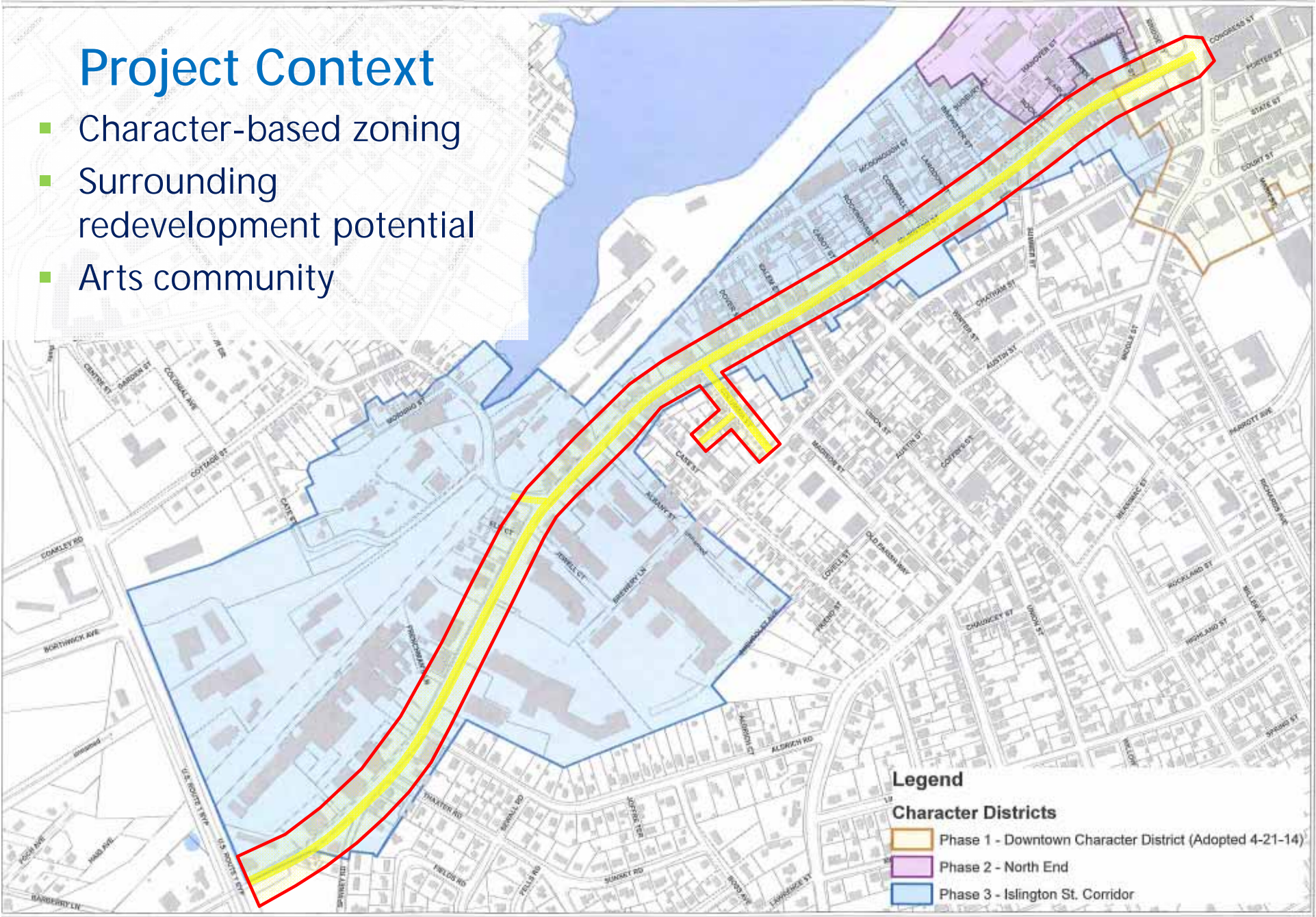

Legend

Character Districts

- Phase 1 - Downtown Character District (Adopted 4-21-14)
- Phase 2 - North End
- Phase 3 - Islington St. Corridor



- THE WEST END: ISLINGTON STREET CORRIDOR PRELIMINARY VISION PLAN



- THE WEST END: ISLINGTON STREET CORRIDOR PRELIMINARY VISION PLAN



Historic District Map

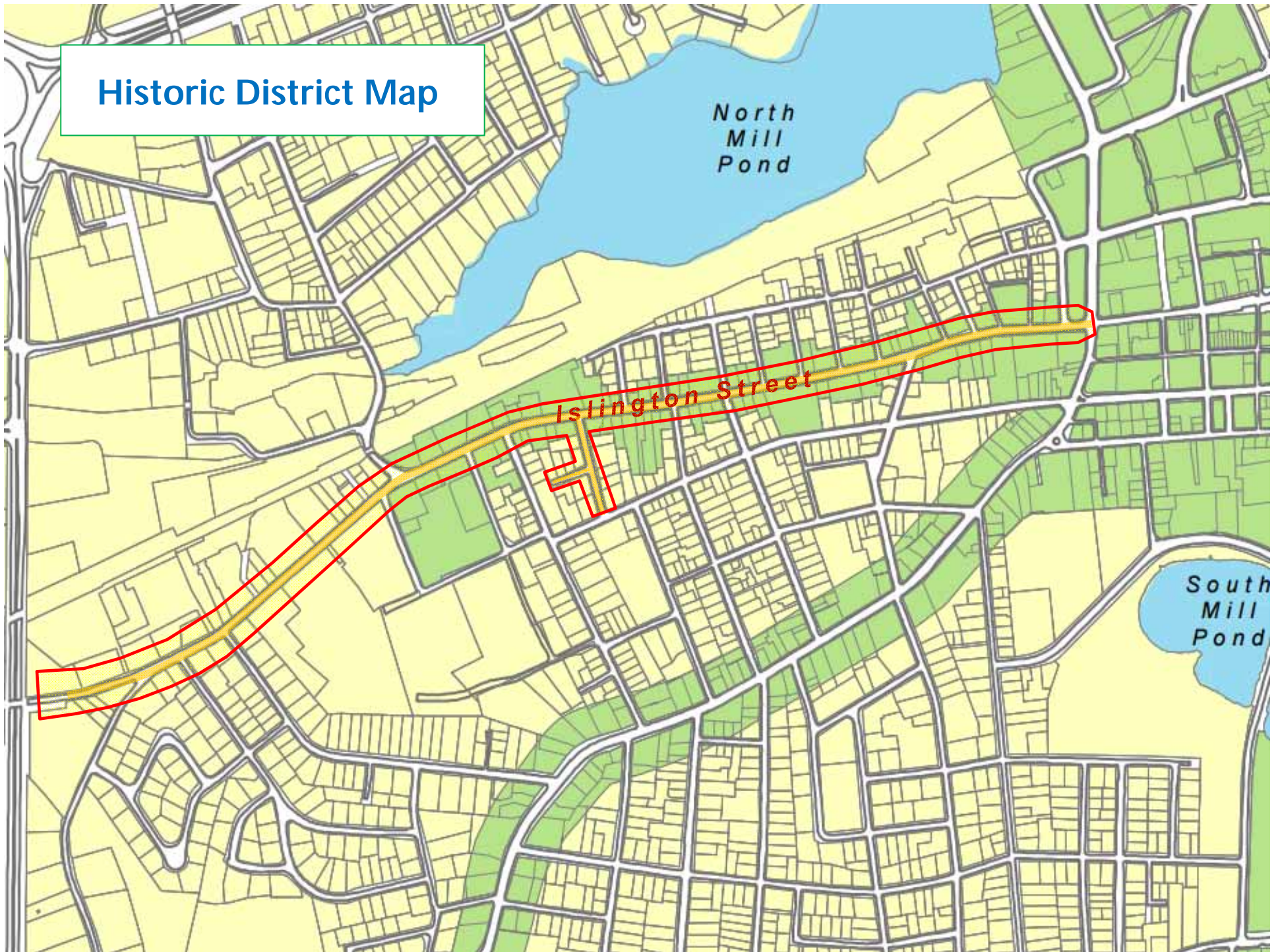

North
Mill
Pond

Islington Street

South
Mill
Pond

Streetscape Amenities

- Trees and plantings
- Lighting
- Gateways
- Bike racks
- Street furniture
- Sidewalk materials
- Wayfinding

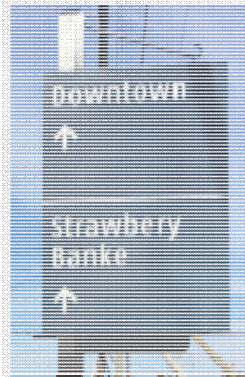

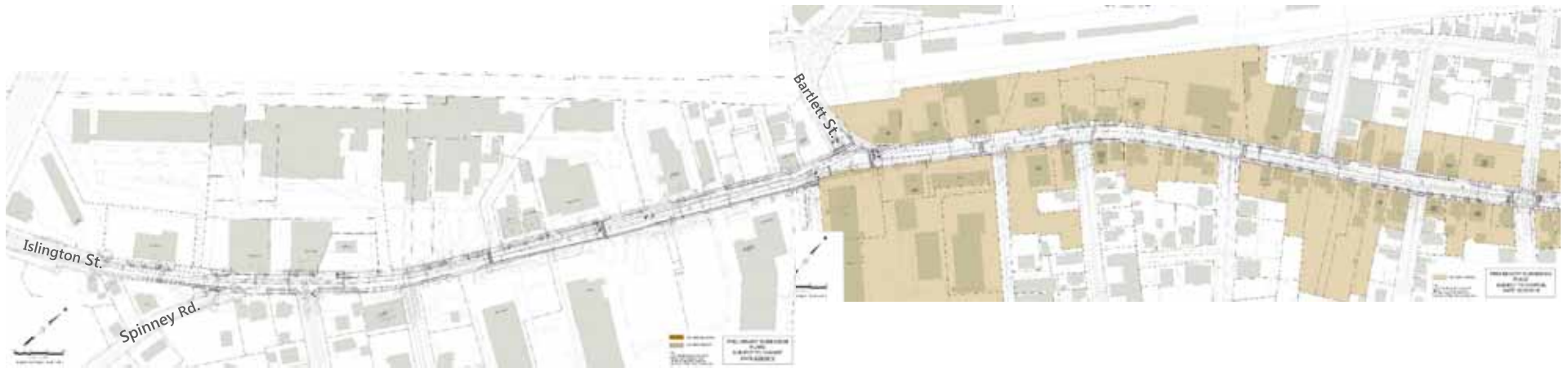

Historic Parcels and Historic Structures

Portsmouth, NH | City of Portsmouth



"Green Pillar" Pin Oak



Red Maple



Pin Oak

- BUILDINGS ON R.O.W.
- BUILDINGS WITHIN 10' OF R.O.W.
- BUILDINGS MORE THAN 10' FROM R.O.W.





Amelanchier Serviceberry



- OVERHEAD UTILITY LINE
- OVERHEAD STREET LIGHT



Building Proximity to R.O.W.
 Portsmouth NH | City of Portsmouth

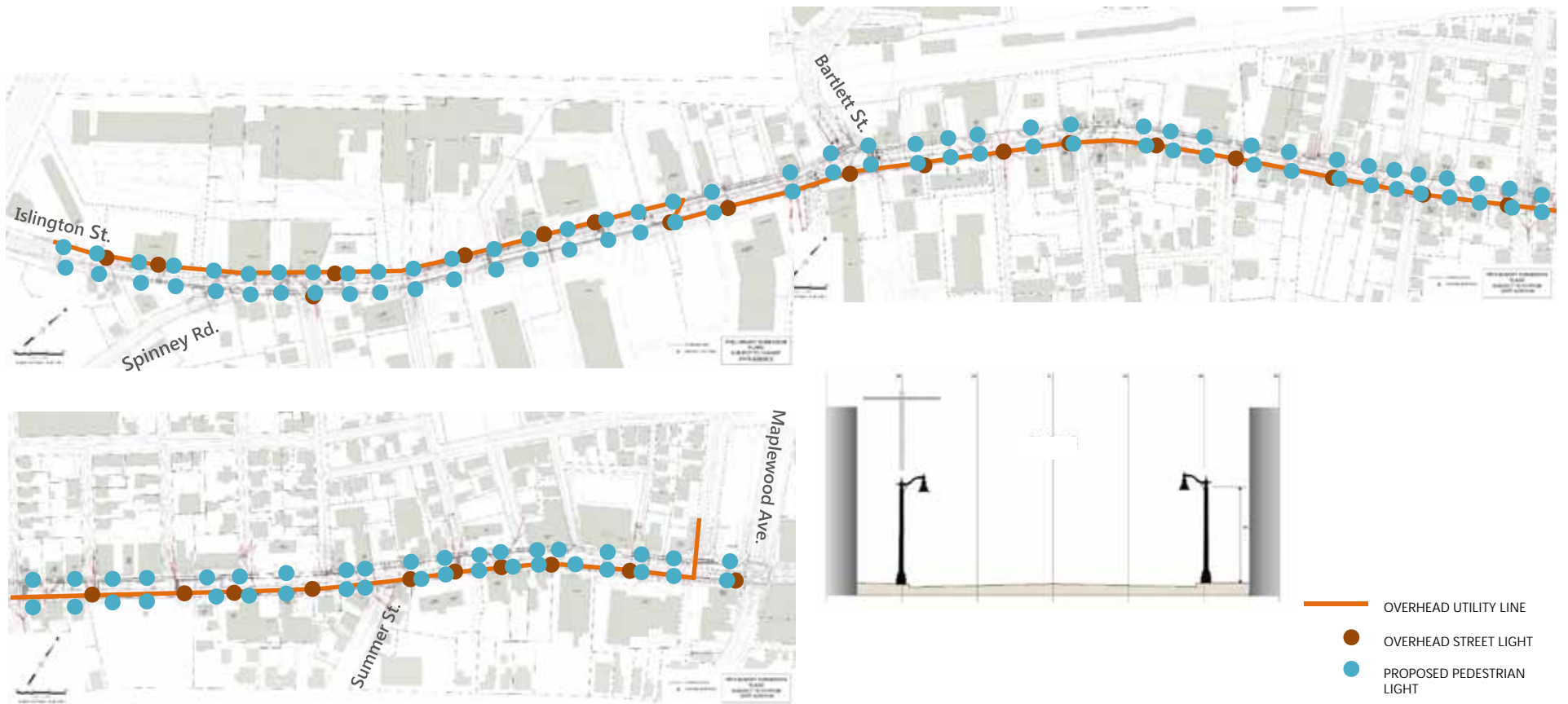

Building Proximity to R.O.W.
 Portsmouth NH | City of Portsmouth

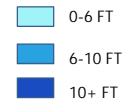
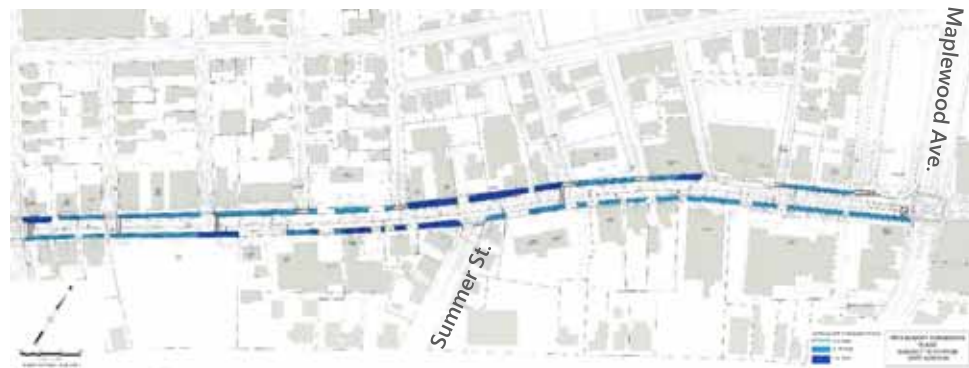
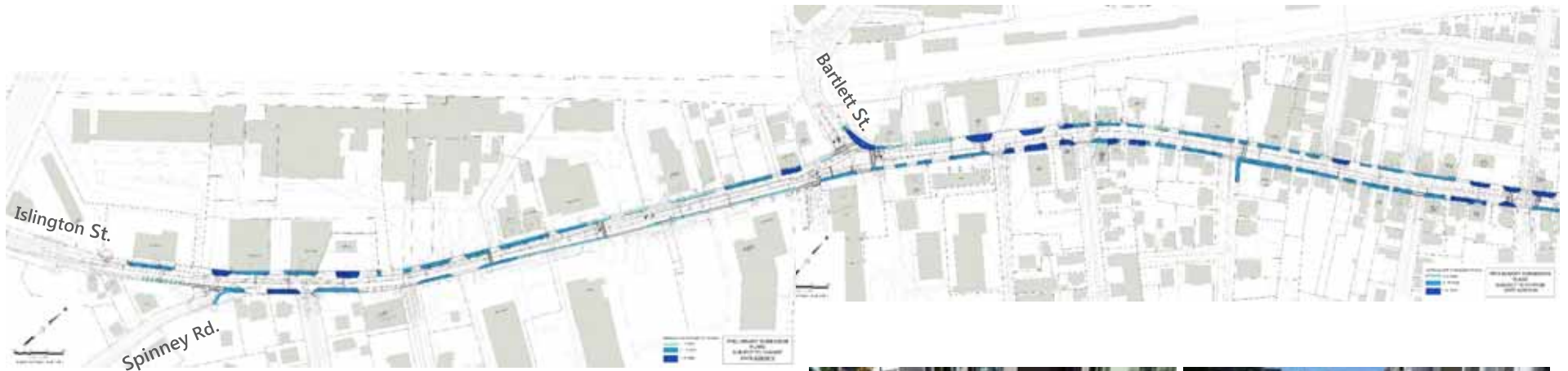

Available Sidewalk Widths

Portsmouth, NH | City of Portsmouth

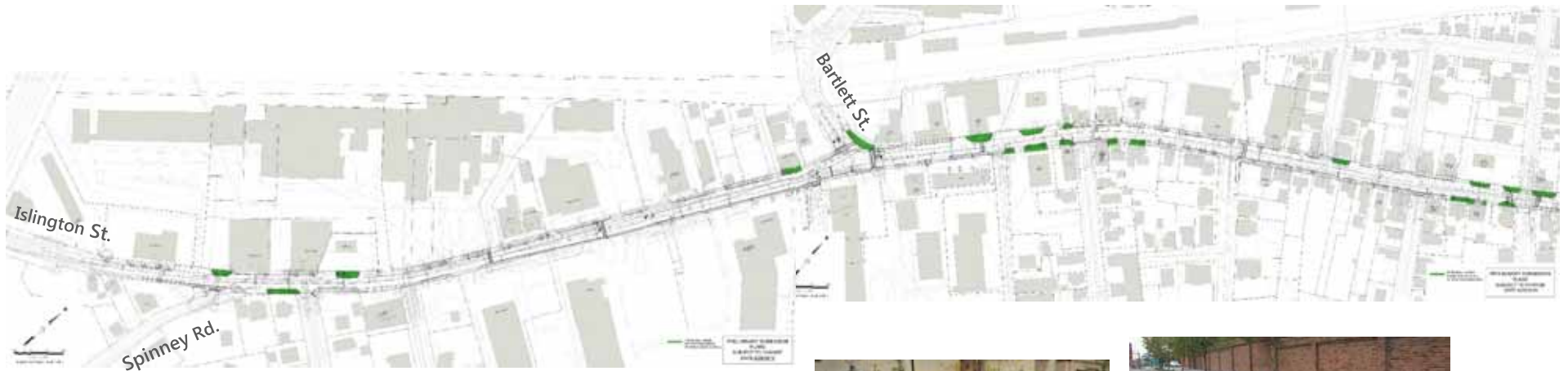

Urban Stormwater Treatment BMP



Possible Urban Stormwater BMP Locations

Portsmouth, NH | City of Portsmouth

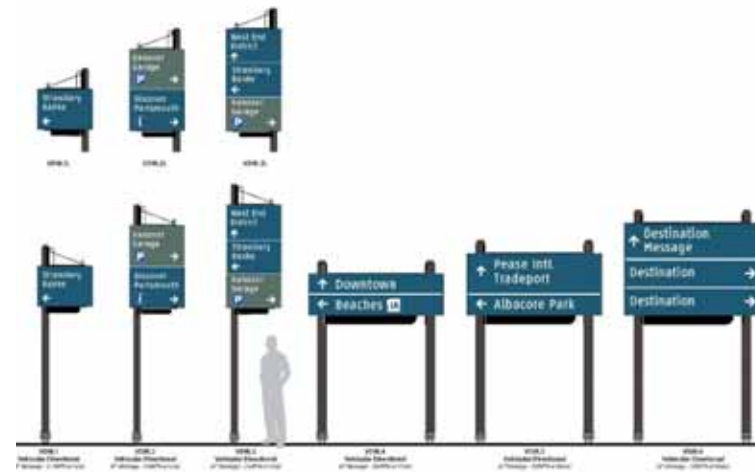
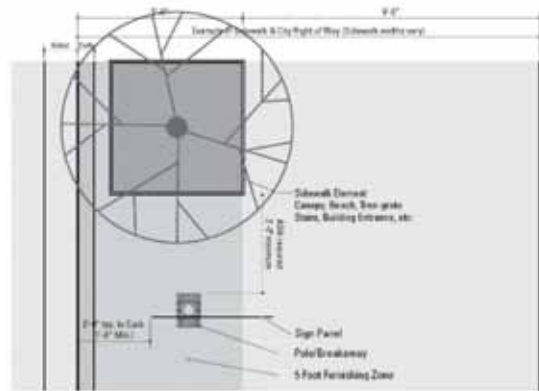
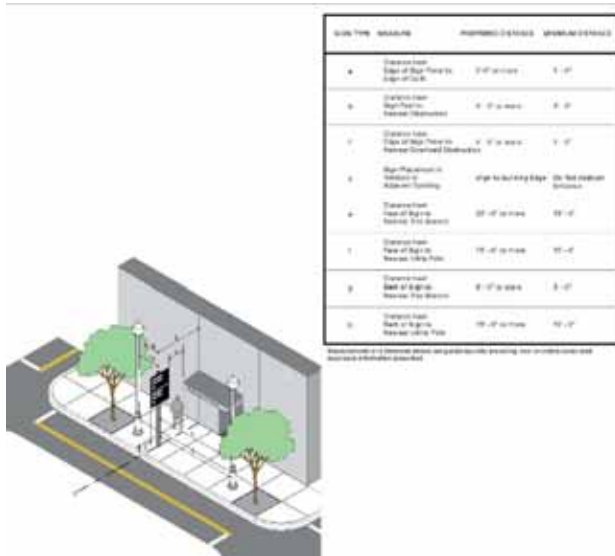

Proposed Streetscape Improvement Plan

Portsmouth, NH | City of Portsmouth

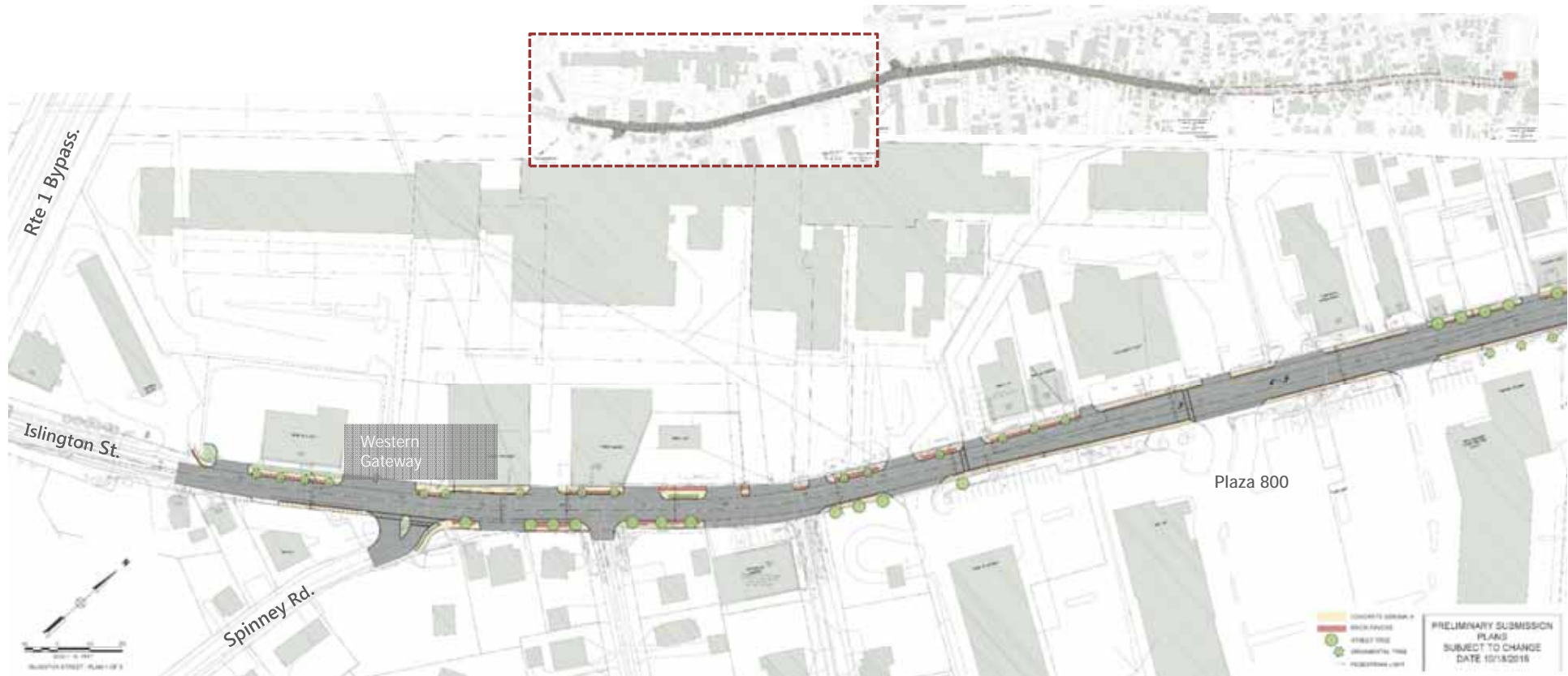

Framework Plan

Portsmouth, NH | City of Portsmouth

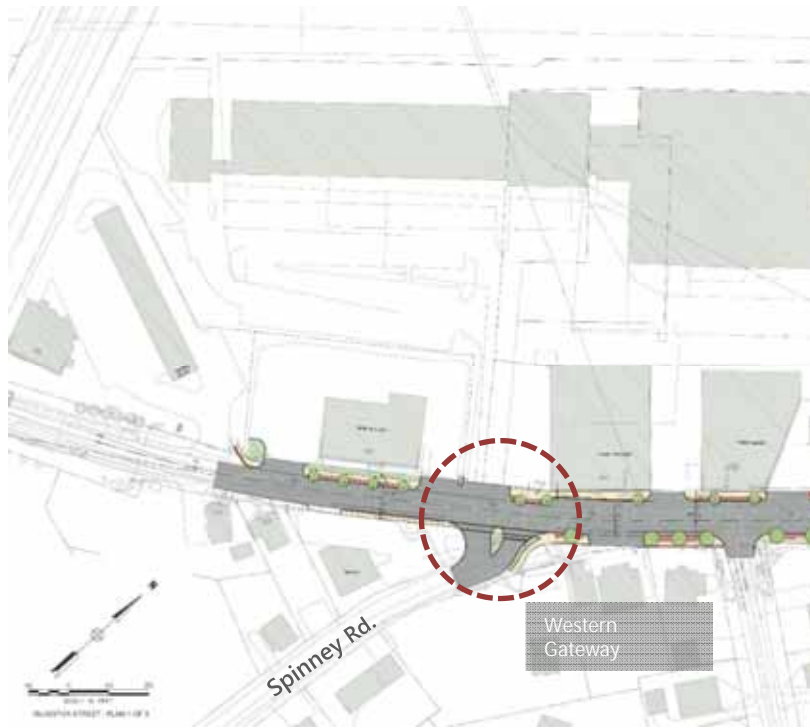

Western Gateway

	CONCRETE SIDEWALK BRICK PAVING STREET TREES ORNAMENTAL TREES PEDESTRIAN LIGHTS
PRELIMINARY SUBMISSION PLANS SUBJECT TO CHANGE DATE 10/14/2016	



Framework Plan

Portsmouth, NH | City of Portsmouth



Proposed Streetscape Improvement Plan

Portsmouth, NH | City of Portsmouth

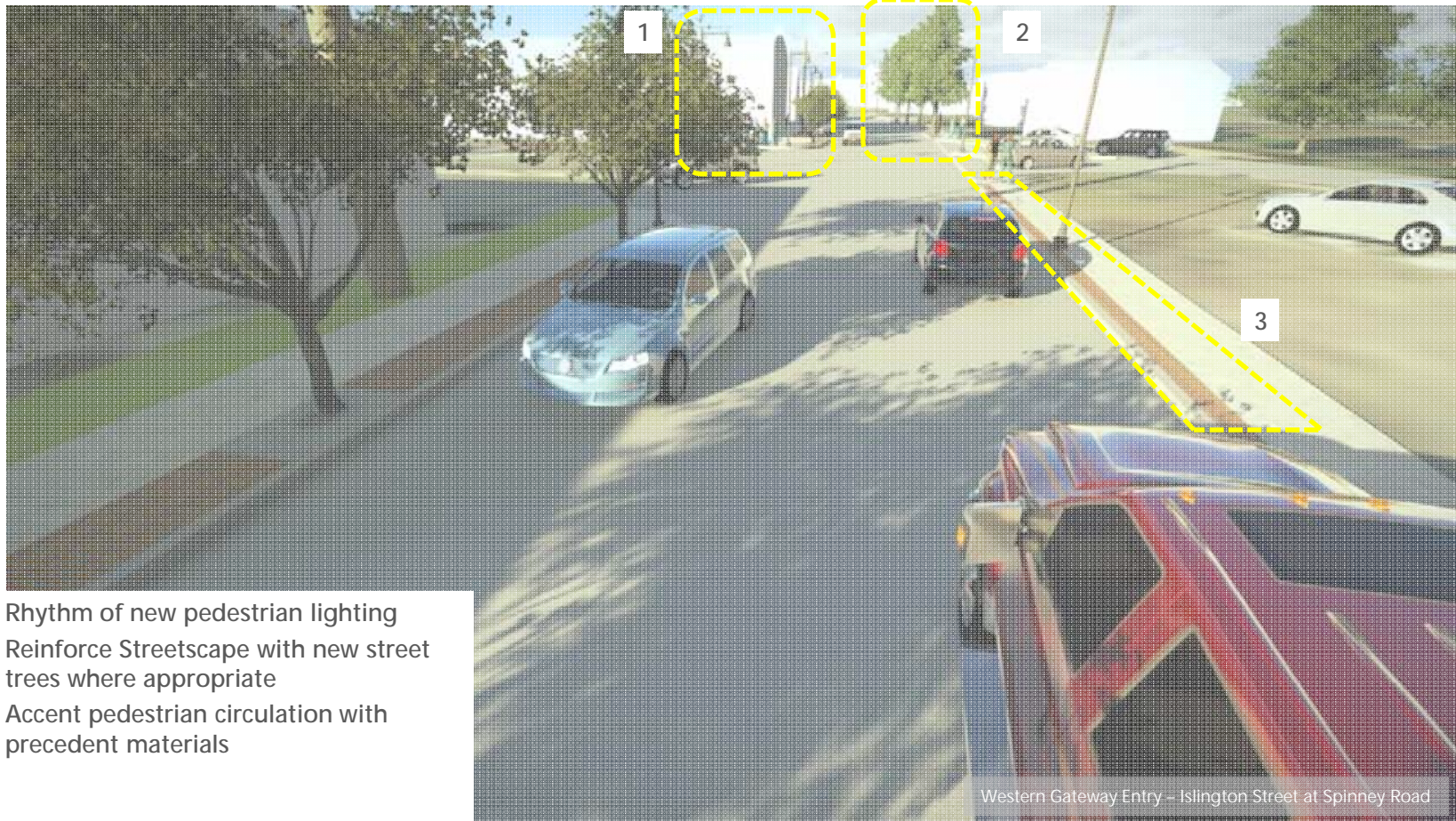

1. Rhythm of new pedestrian lighting
2. Reinforce Streetscape with new street trees where appropriate
3. Accent pedestrian circulation with precedent materials

Western Gateway Entry – Islington Street at Spinney Road



Proposed Streetscape Improvement Plan

Portsmouth, NH | City of Portsmouth

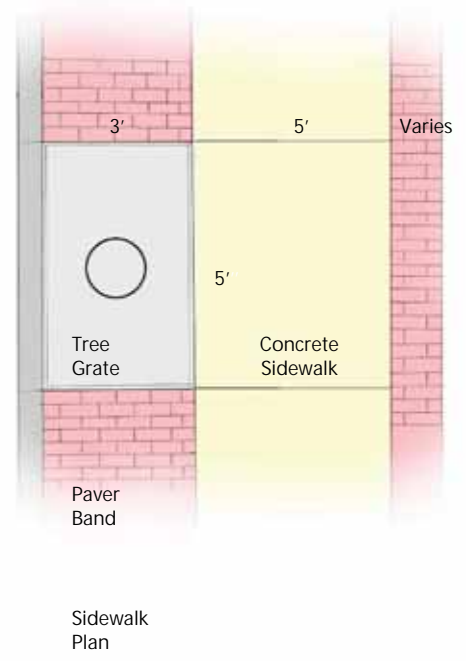

Proposed Streetscape Improvement Plan

Portsmouth, NH | City of Portsmouth

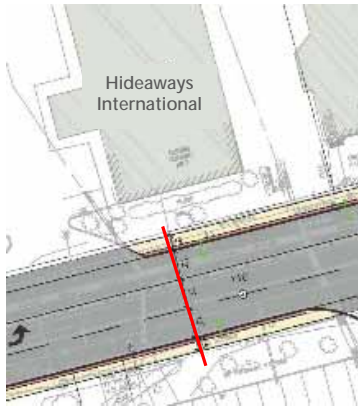

CONSTRAINED SECTION- 12' CENTER TURN LANE

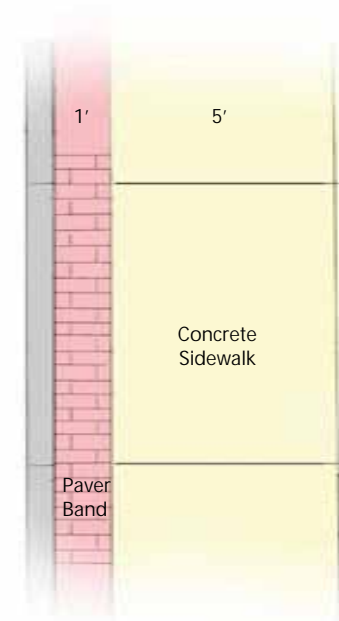

Sidewalk Plan



Proposed Streetscape Improvement Plan

Portsmouth, NH | City of Portsmouth

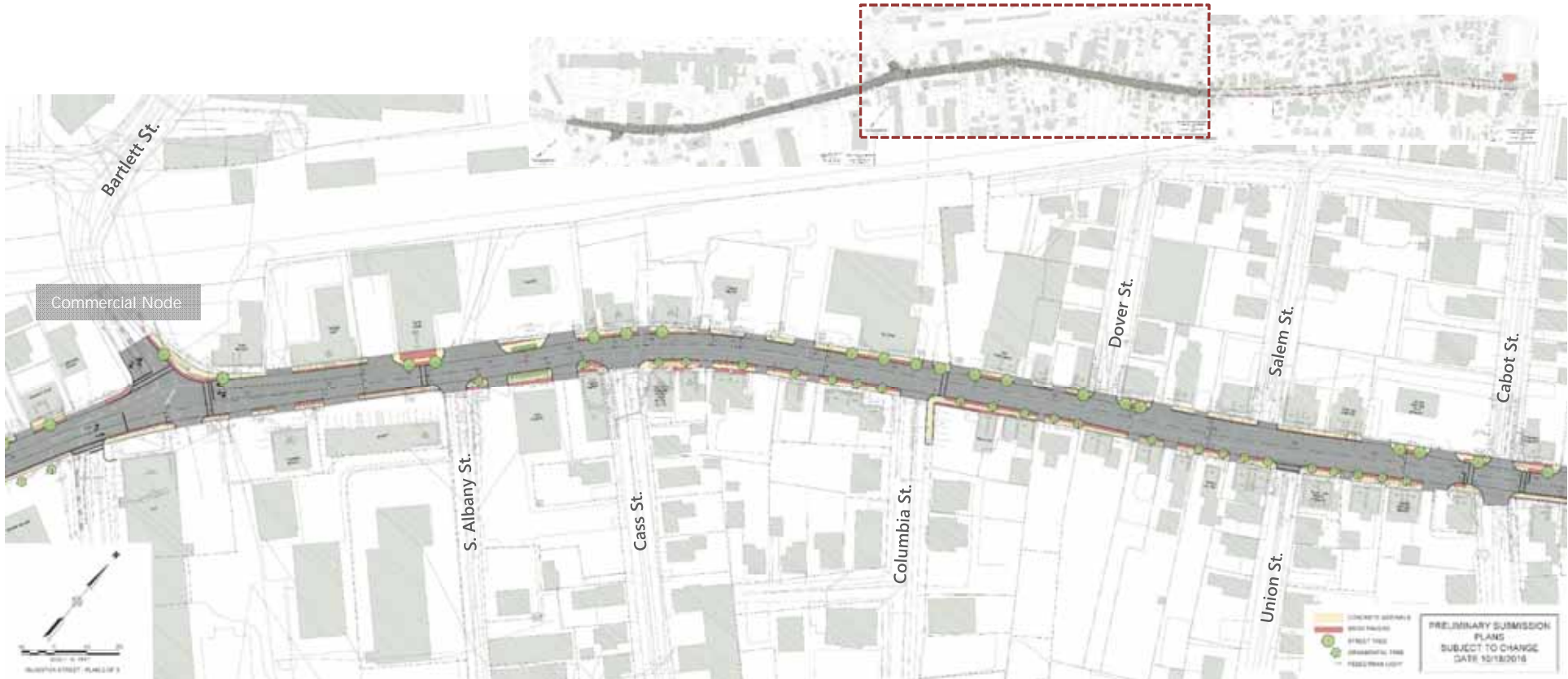

Framework Plan

Portsmouth, NH | City of Portsmouth

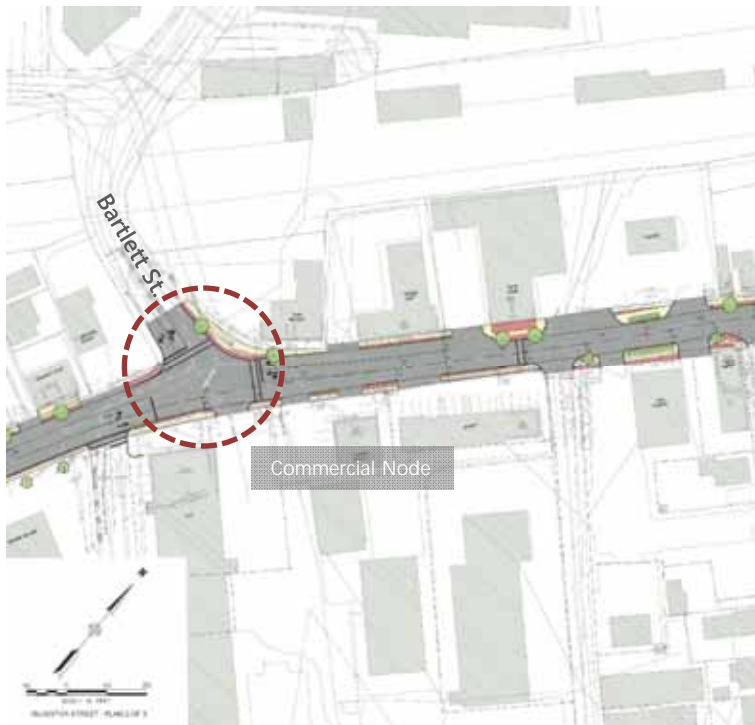

Framework Plan

Portsmouth, NH | City of Portsmouth



Bartlett St. at Islington St Intersection Improvements



Proposed Streetscape Improvement Plan

Portsmouth, NH | City of Portsmouth

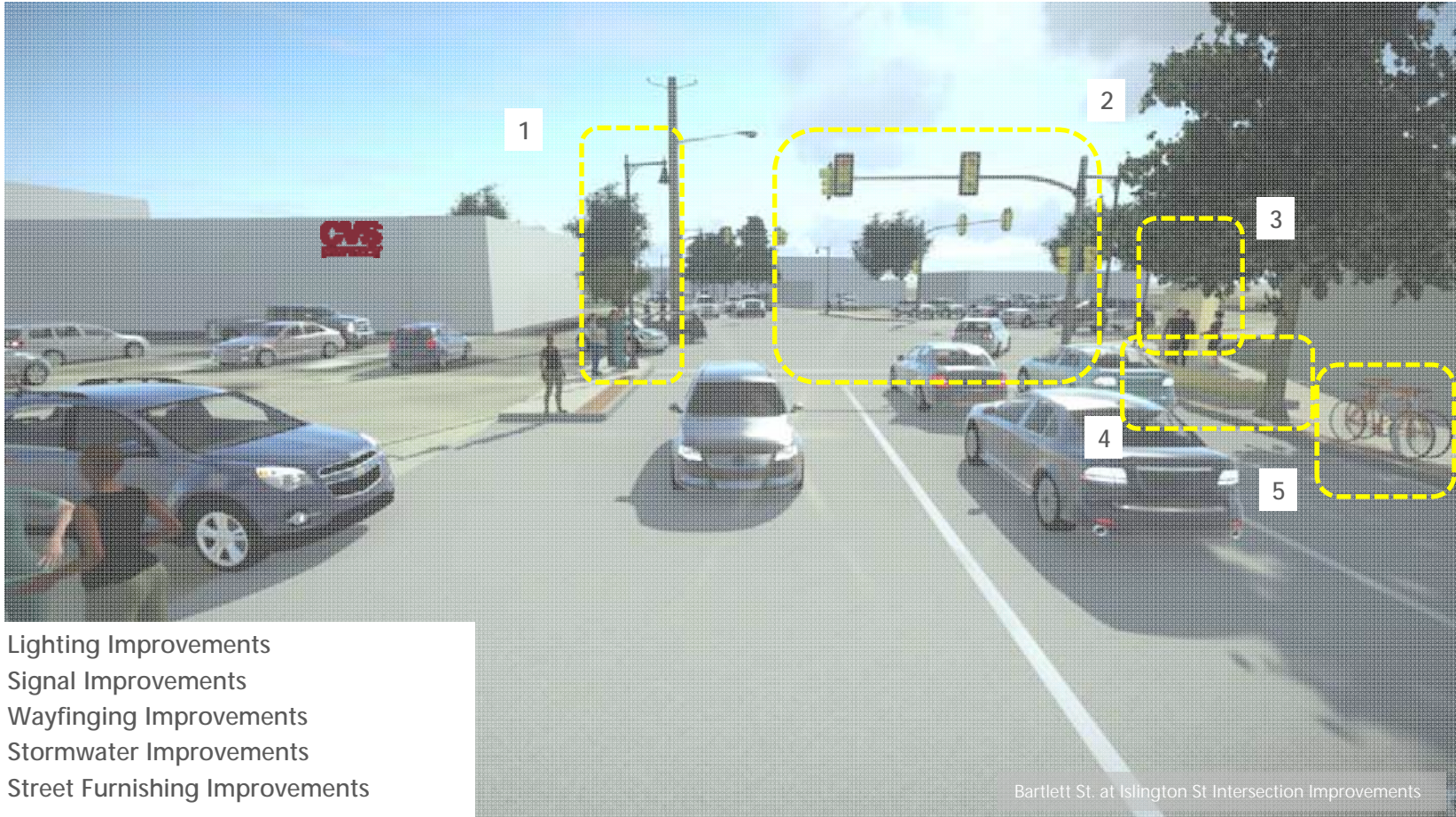

Proposed Streetscape Improvement Plan

Portsmouth, NH | City of Portsmouth

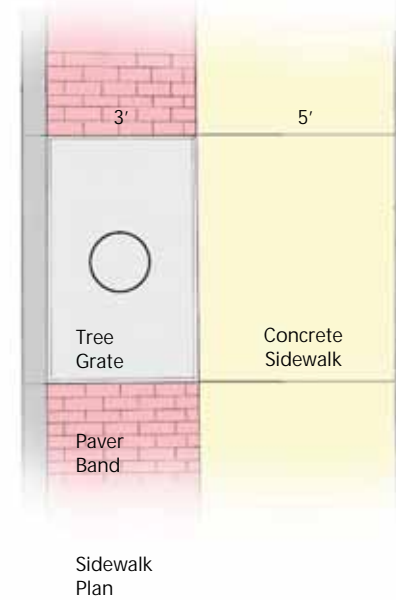
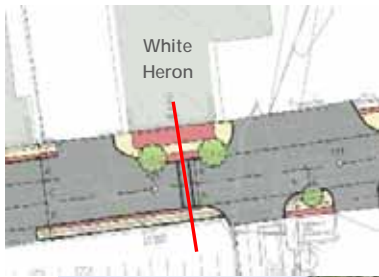

Proposed Streetscape Improvement Plan

Portsmouth, NH | City of Portsmouth

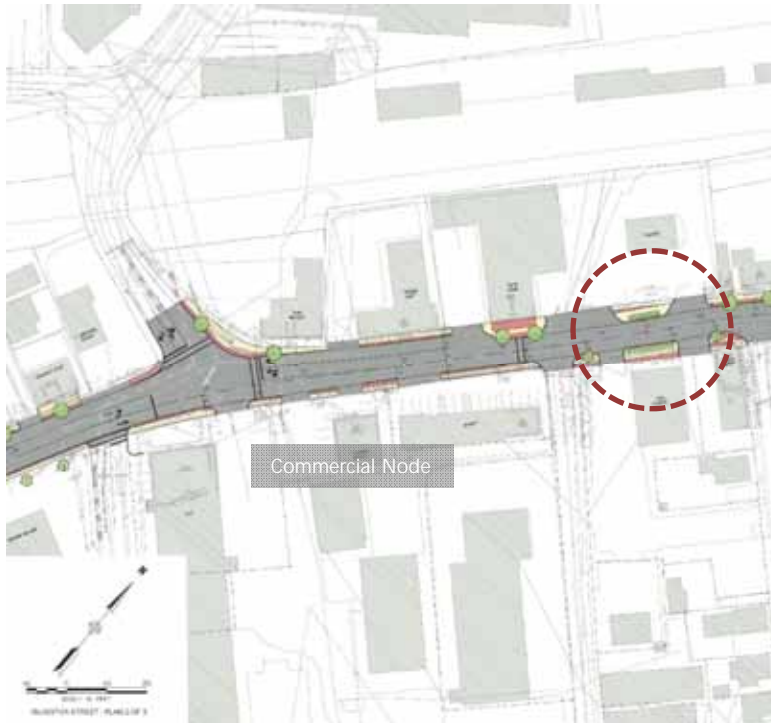

Framework Plan

Portsmouth, NH | City of Portsmouth



Case Street Intersection Streetscape Improvements



Proposed Streetscape Improvement Plan

Portsmouth, NH | City of Portsmouth



1. Encourage innovative means of stormwater management.
2. Identify opportunities for café seating to activate the streetscape



Proposed Streetscape Improvement Plan

Portsmouth, NH | City of Portsmouth

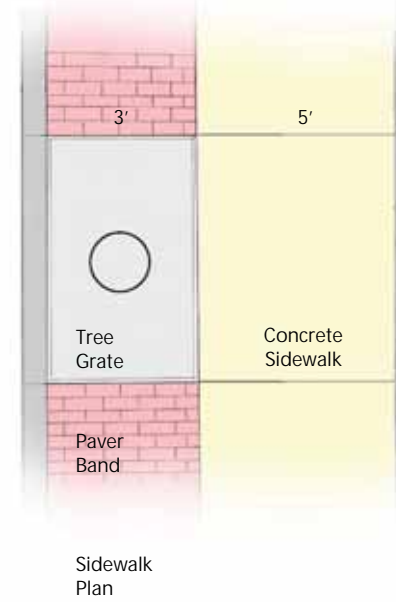

Proposed Streetscape Improvement Plan

Portsmouth, NH | City of Portsmouth

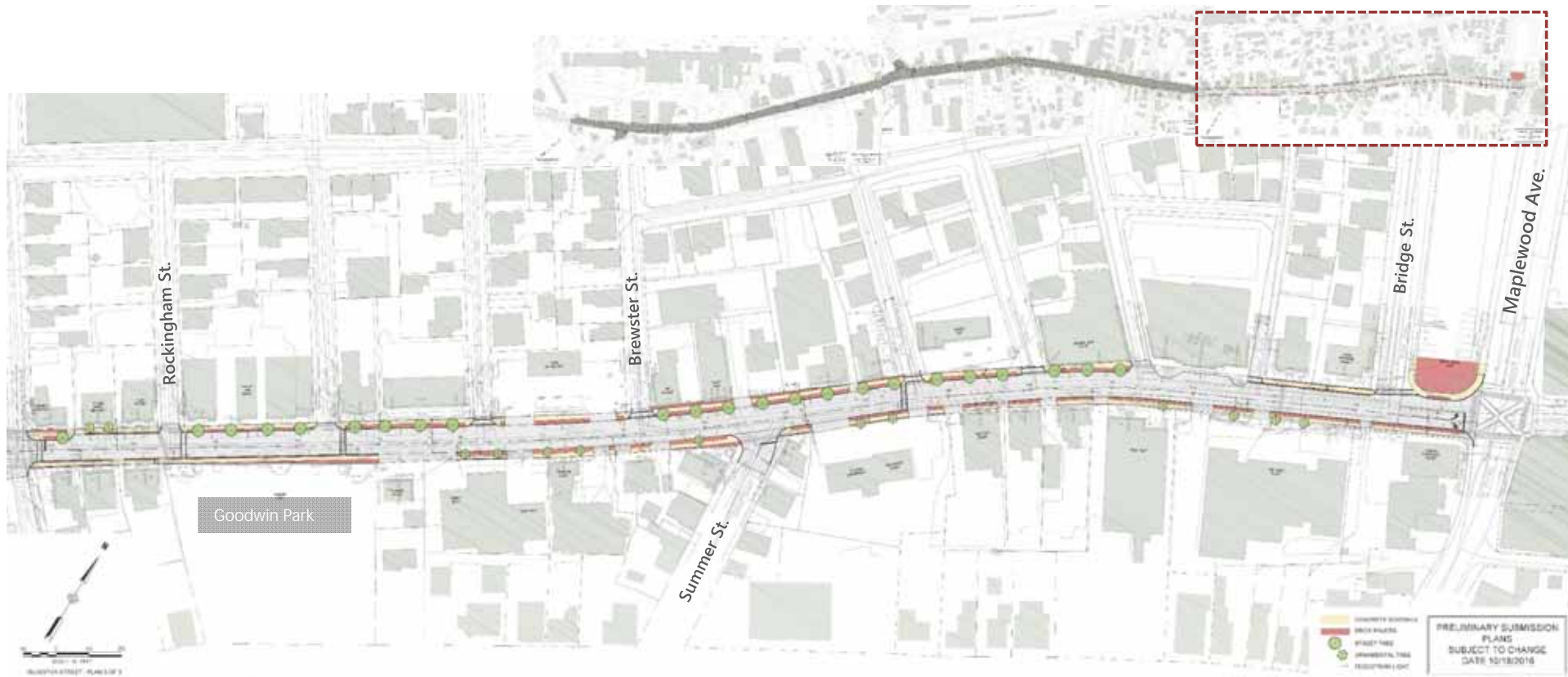

Framework Plan

Portsmouth, NH | City of Portsmouth



LEGEND

- CONCRETE SIDEWALK
- BRICK PAVEMENT
- GRAVEL DRIVE
- UNPAVED DRIVE
- EXISTING DRIVE

PRELIMINARY SUBMISSION
PLANS
SUBJECT TO CHANGE
DATE: 02/18/2016



Framework Plan

Portsmouth, NH | City of Portsmouth



Proposed Streetscape Improvement Plan

Portsmouth, NH | City of Portsmouth



1. Introduce wayfinding at civic spaces that adhere to the city standards
2. Identify area to accommodate bike parking at civic spaces
3. Improve visibility and locations of crosswalks.



Proposed Streetscape Improvement Plan

Portsmouth, NH | City of Portsmouth



Framework Plan

Portsmouth, NH | City of Portsmouth



Framework Plan

Portsmouth, NH | City of Portsmouth



Eastern Gateway Entry – Islington Street at Maplewood Ave/Middle Street



Proposed Streetscape Improvement Plan

Portsmouth, NH | City of Portsmouth

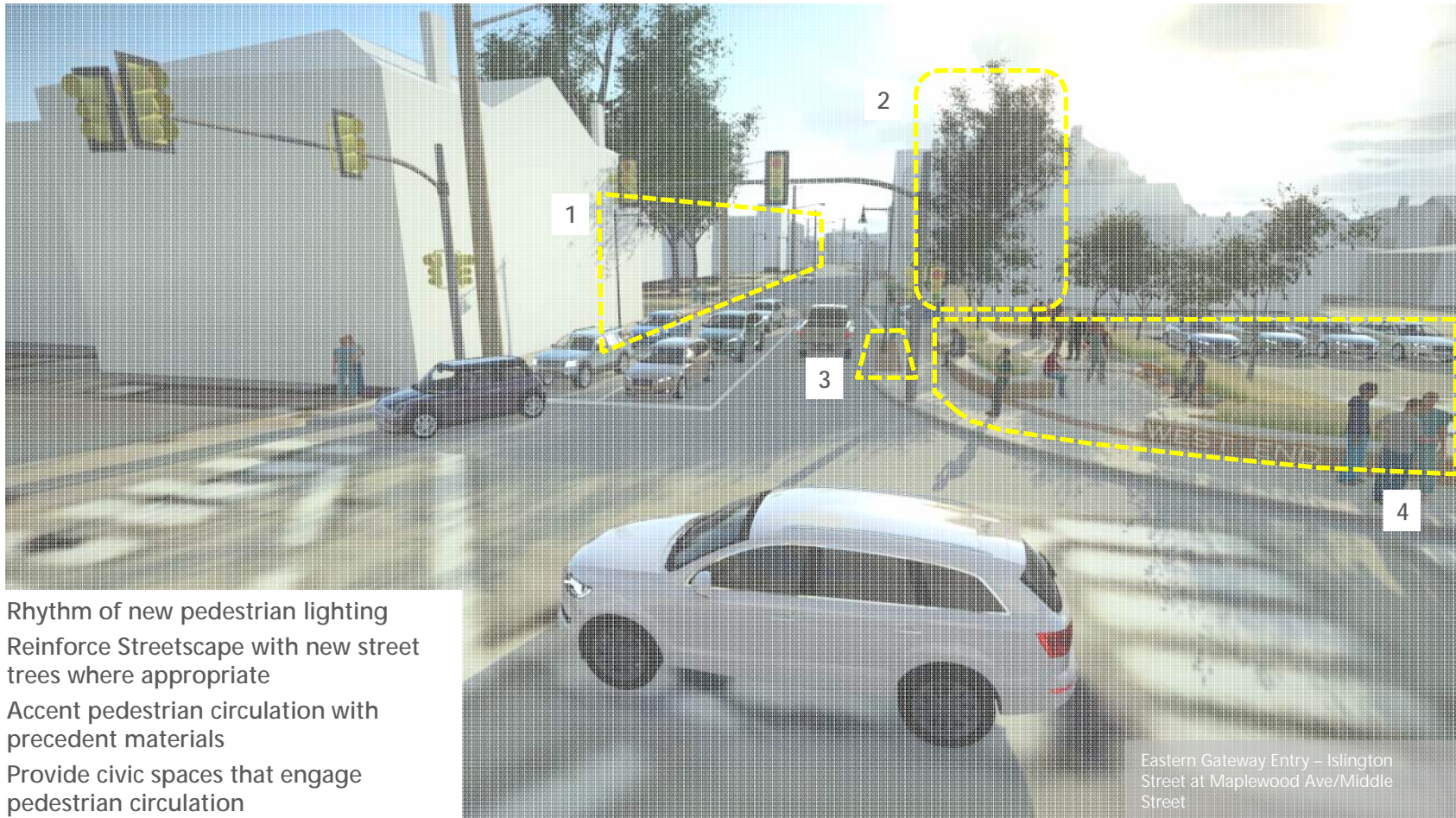

- 1. Rhythm of new pedestrian lighting
- 2. Reinforce Streetscape with new street trees where appropriate
- 3. Accent pedestrian circulation with precedent materials
- 4. Provide civic spaces that engage pedestrian circulation

Eastern Gateway Entry – Islington Street at Maplewood Ave/Middle Street



Proposed Streetscape Improvement Plan

Portsmouth, NH | City of Portsmouth

Next Steps

- Roadway Borings in late 2016
- Finalize Preliminary Design in early 2017
- Identify Initial Contract Limits for Final Design and Construction
- Construction Schedule Largely Dependent on Funding
- \$5.5 Million Currently Allocated F.Y. 2018



Please Share Your Questions and Comments



Offices located throughout the East Coast

Load Roll Plan



Proposed Streetscape Improvement Plan

Portsmouth, NH | City of Portsmouth



Branding the Corridor
 Portsmouth, NH | City of Portsmouth

